



DELIVERING EXCELLENCE

TZone 1, 2 & 3 (External Engine Temperature) Thermocouples & RTDs

FEATURES

- K Type, Class 1/Special Limits thermocouple
- Robust, glass encapsulated high purity Platinum 100Ω RTD
- Simplex and Duplex units
- Multiple connection options
- Hermetically sealed
- Optimised design to suit engine application
- LRU designs for ease of lifecycle maintenance
- Corrosion resistant, robust designs for extreme aerospace environments

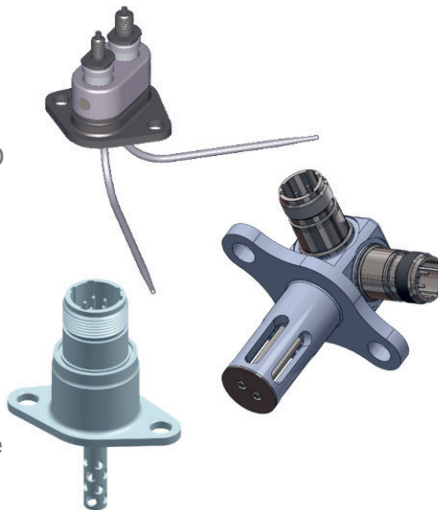

BENEFITS

- Millions of cumulative flying hrs
- High accuracy
- Low drift (stable accuracy)
- Fast response time
- Lightweight design
- Reliable and long life
- Proven technology with over 20 years of pedigree
- High levels of dielectric and insulation resistance

APPLICATIONS

- RR: Trent 500, Trent 700, Trent XWB,
- Nordam: Nacelle

■ Auxitrol Weston's TZone1, 2 & 3 Thermocouples and RTDs have been individually designed for and certified on multiple engines for various customers. These TZone1, 2 & 3's have amassed millions of flight hours.

■ Design options include Compact designs with Connector, Terminal or flying lead terminations bespoke engine mounting fixing points and shielded/ protected sensors.

■ High accuracy is achieved by the use of BS EN 60584-2 Class 1 or ASTM E230M special Limits Type K thermocouple materials for the entire circuit, with optimum response time (time constant) achieved by swaging the element to a small diameter.

■ High accuracy is achieved by the use of high purity Platinum 100 Ohm resistances RTDs with outputs in accordance with the Callendar-Van Dusen equation

Typical Performance Specification

Measured temperature	T/Cs -55°C up to 600°C (higher temperatures can be achieved by using other pedigree materials) RTDs -55°C up to typically 300°C (higher temperatures up to 500°C are also possible).
Output	T/Cs BS EN 60584-2 class 1/ ASTM E230M Special Limits, Type K
RTD Resistance, 100 Ohms at 0°C,	
RTD Accuracy	±2.5°C over the normal operating range
Insulation Resistance	>1GΩ at 500V DC
Life	>80,000 Operating Hours (depending on flight temperature profile)
Reliability	Typically >2,000,000 Flight Hours (MTBF)
Terminals or Connectors	EN2997 or ESC10 etc Ni/Cr: 10-32 UNF-2A thread, Ni/Al: ¼ UNF-2A thread

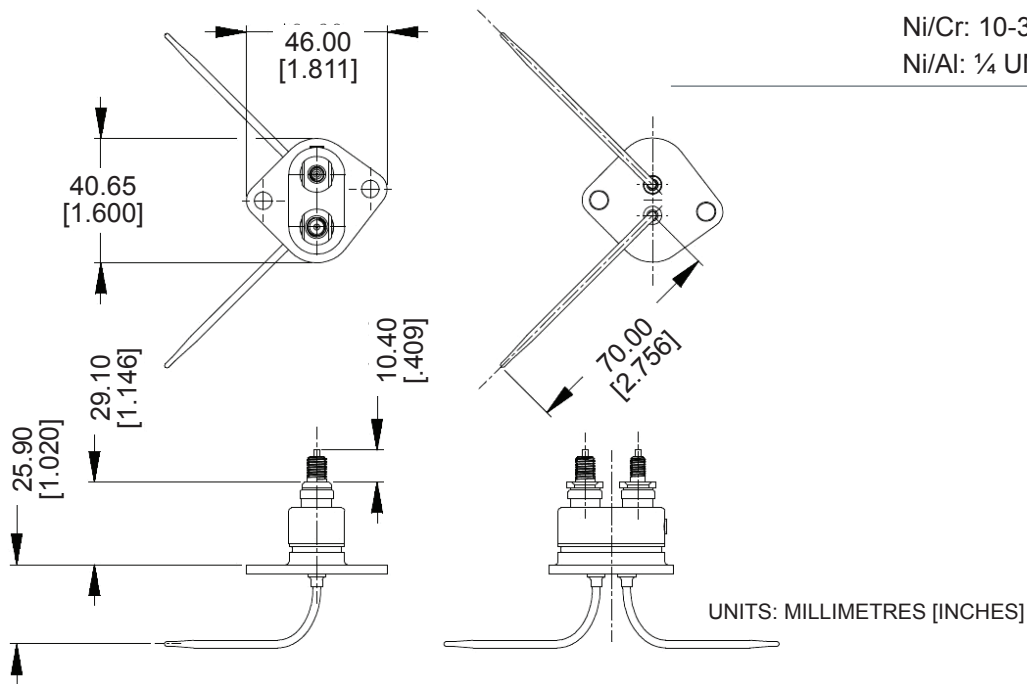

Examples shown above are for information, dimensions can be modified to meet unique installations

SALES :

- Auxitrol SAS
5 allée Charles Pathé
ZAC de l'échangeur - CS20006
18023 Bourges Cedex - France
Tel : +33(0) 2 48 66 78 78

- Norwich Aero Products Inc.
50 O'Hara Drive
P.O Box 109
Norwich, NY 13815-0109 - USA
Tel: +1 (607) 373 4447

- Weston Aerospace Ltd
124 Victoria Road
Farnborough, Hampshire,
GU14 7PW - United Kingdom
Tel: +44 (0) 1252 544 433

AFTER - SALES SUPPORT :

- Auxitrol SAS
5 allée Charles Pathé
ZAC de l'échangeur - CS20006
18023 Bourges Cedex - France
Tel : +33(0) 2 48 66 78 78

- Auxitrol Weston Singapore
30 Loyang Way - #06-06
Singapore 508769
Tel: +65 6546 7648